

Creating a Pre-Op Assessment

- 1 Log In**
Open mediSIGHT. Enter Username, Password then click **Login**.

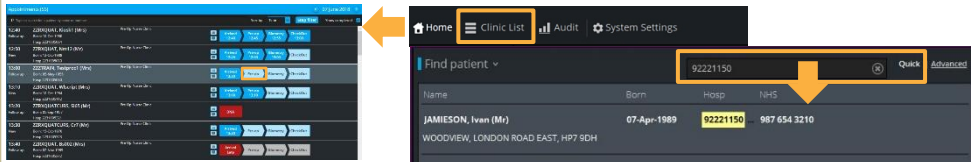

- 2 Find Patient**
Click on the **Clinic List** step or type the Hospital/NHS Number in Quick search. Select the search result to open the record.



- 3 Create Event**
Check the patient details at the top before you start.

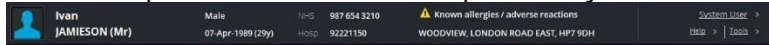

Click on **Create new +**
Select **Pre-op assessment**

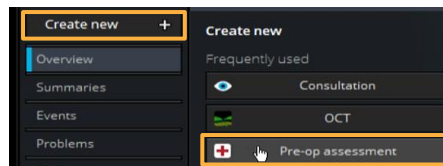

- 4 Enter Data**
Click on a section to expand it. Click **Done** as you enter data to collapse that section. You must complete all * fields.

Pre-operative assessment

Pathway * Macular Treatment Location * Eye Clinic (WH)

Date * 18-May-2018 Responsible

Seen by * Ms Sarah LEWIS

In clinic By telephone

Is data entered for the correct eye? Done

- 5 Save and Print**
Use the **Finalise** button to save and confirm the data. Print-outs will be sent to your default printer.

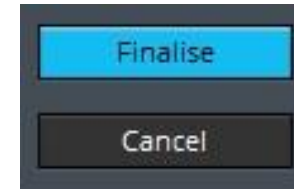

- 6 Check Biometry**
Go to the **Events** list to check the Biometry data.



- 7 Edit Data**
Find the event and use the crayon if you need to edit the data.

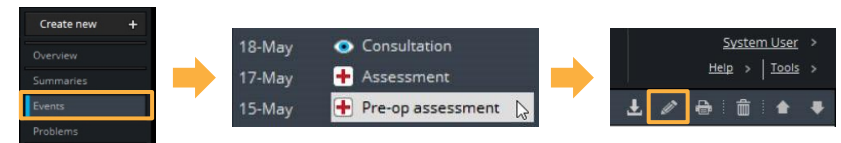

- 8 Log Out**
Use your profile drop-down menu to **Log out** when finished.

